

Modellname:
Nazwa modelu:

DOVER

Modellreihe:
Numer modelu:

SL -- 08

Type: **16**
Typ:

Blatt Nr **1** von: **6**
Strona z:

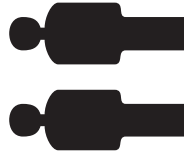

2 Personen
2 Osoby

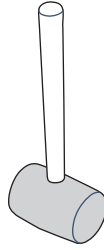
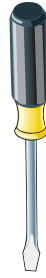
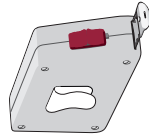

MONTAGEAUFLEITUNG

INSTRUKCJA MONTAŻOWA

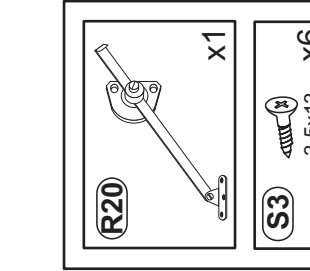
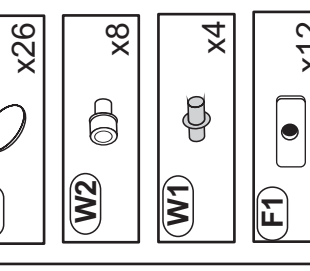
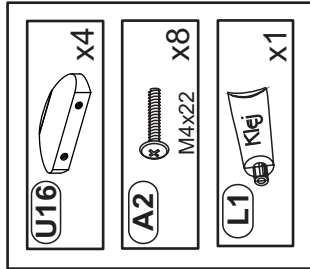
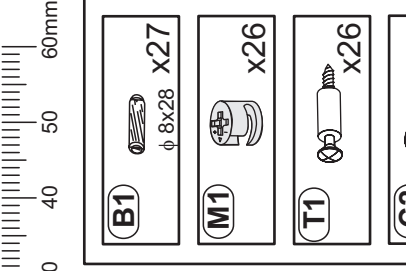
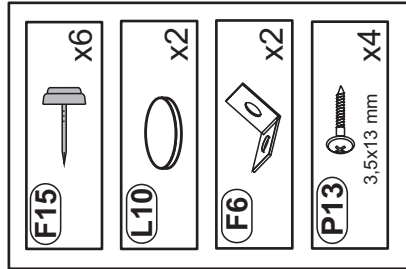
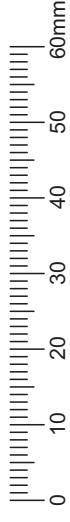
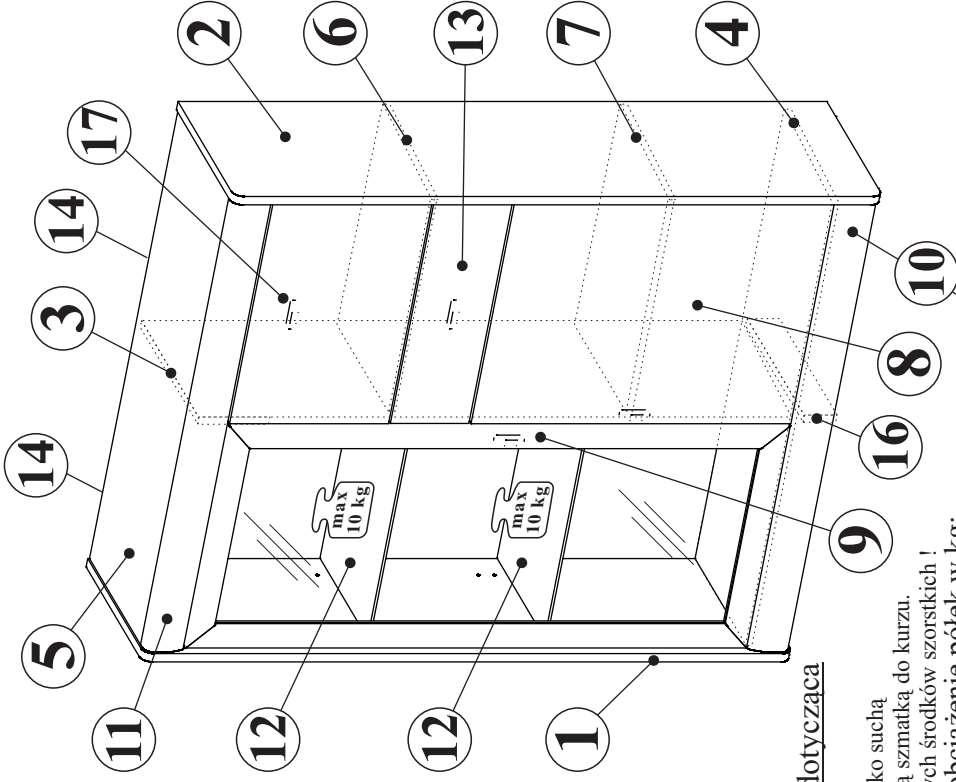

Wskazówka dotycząca

pielegnacji!

Proszę czyścić tylko suchą lub lekko wilgotną szmatką do kurzu.
Nie używać żadnych środków szorstkich!
Maksymalne obciążenie półek w kg:

Stärke/Gr.	Spanplatte/Plyta
Länge/Dł. mm	15 18 22
0<400	
401<600	40 40 40
601<800	24
801<1000	15 30

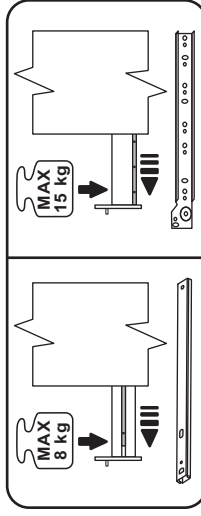

**MONTOWAĆ
NA ROZŁOŻONYM KARTONIE!**

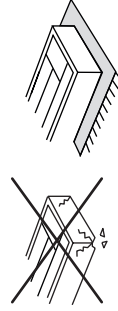

Modellname:
Nazwa modelu:

DOVER

Modellreihe:
Numer modelu:

SL -- 08

Type: **16**
Typ:

Blatt Nr **2** von: **6**
Strona z:

- R1** L-246 mm X2
- E4** 6,0x8,0 X4
- Y5** H2 X7
- E1** 6,3x13 X14
- T1** X12
- B1** ϕ 8x28 X11
- M1** X10
- F15** X6
- W2** X8
- W1** X4

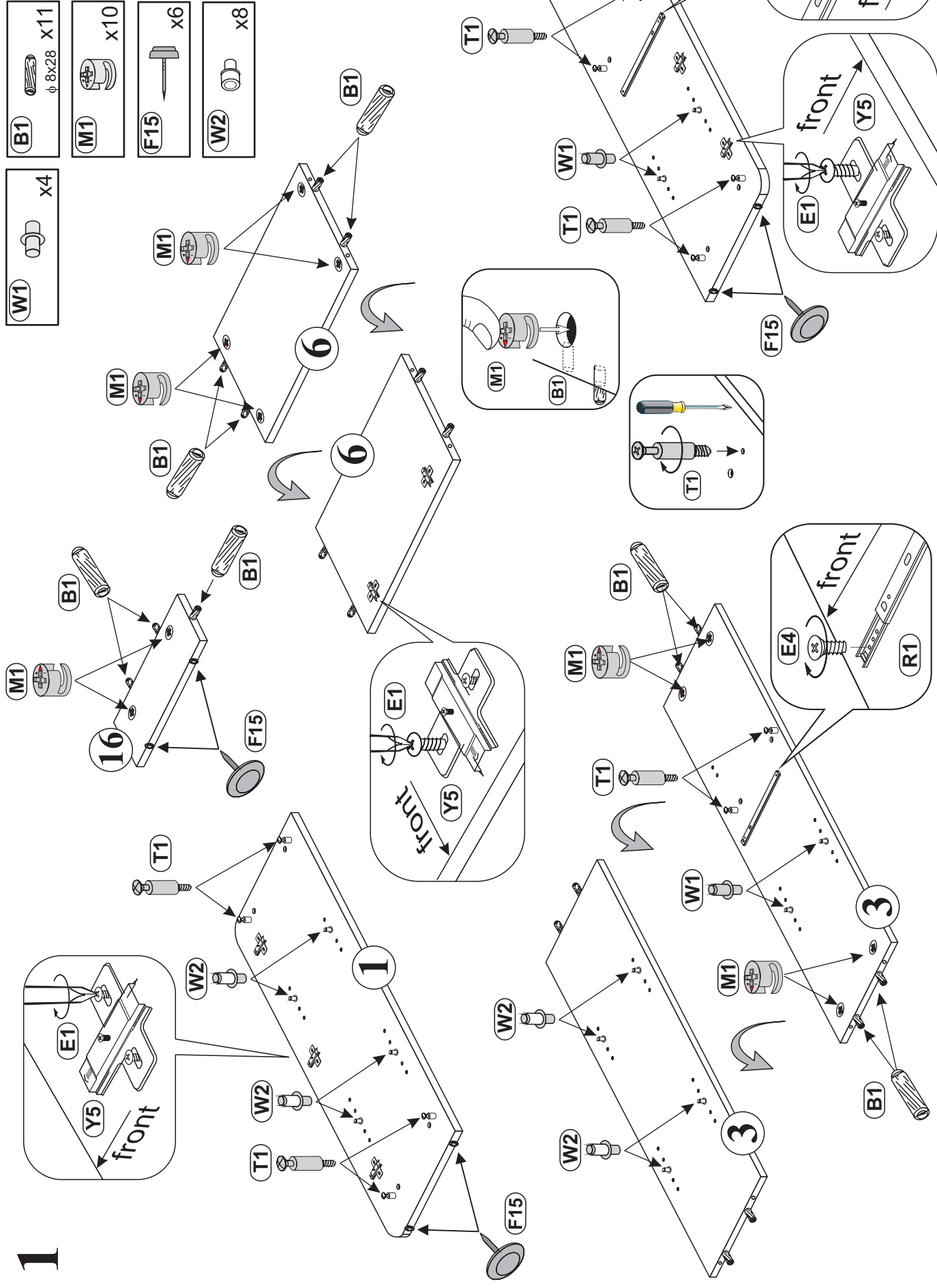

Modellname:
Nazwa modelu:

DOVER

Modellreihe:
Numer modelu:

SL -- 08

Type: **16**
Typ:

Blatt Nr **3** von: **6**
Strona z:

2

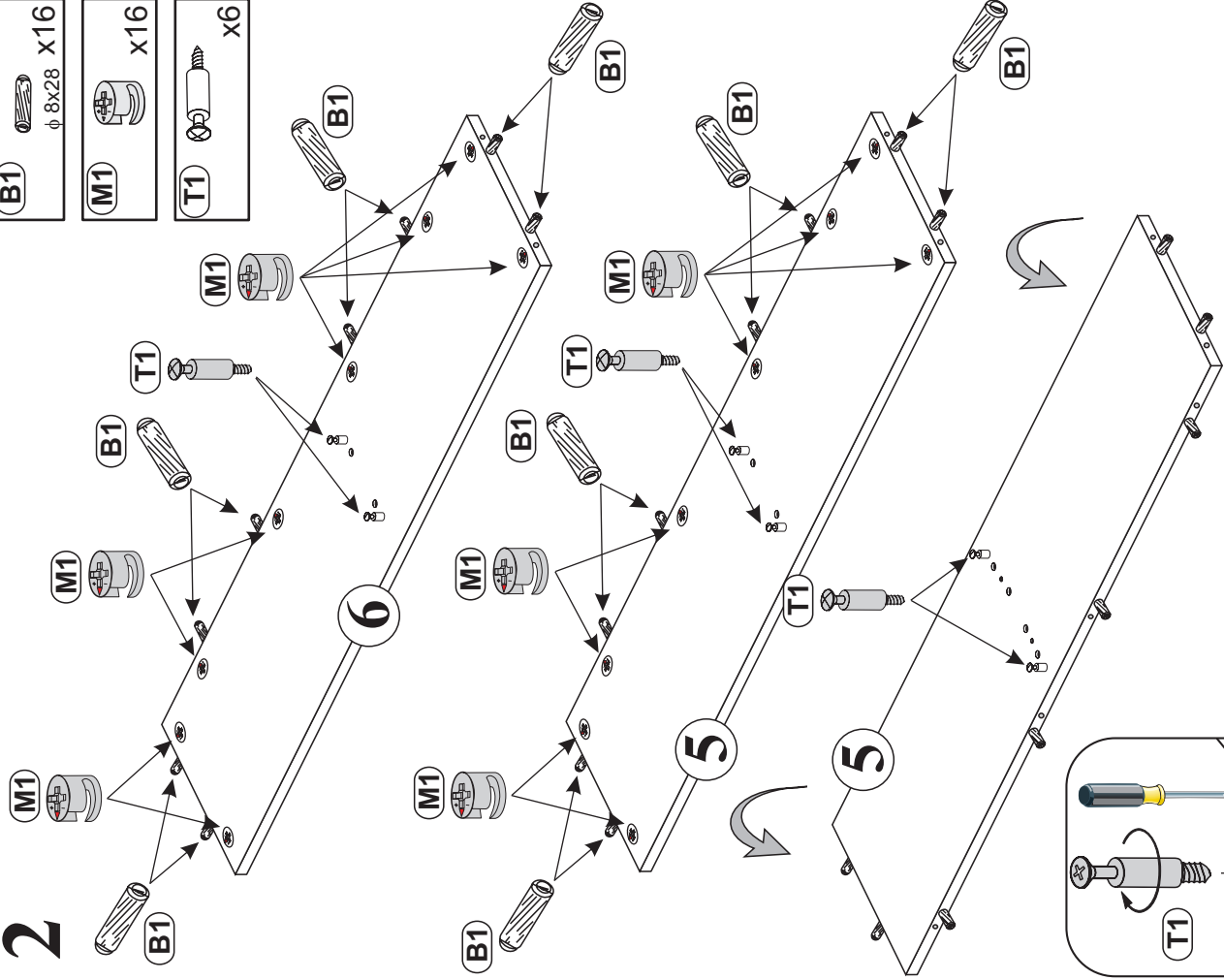

- (B1)** ϕ 8x28 x16
- (M1)** x16
- (T1)** x6

3

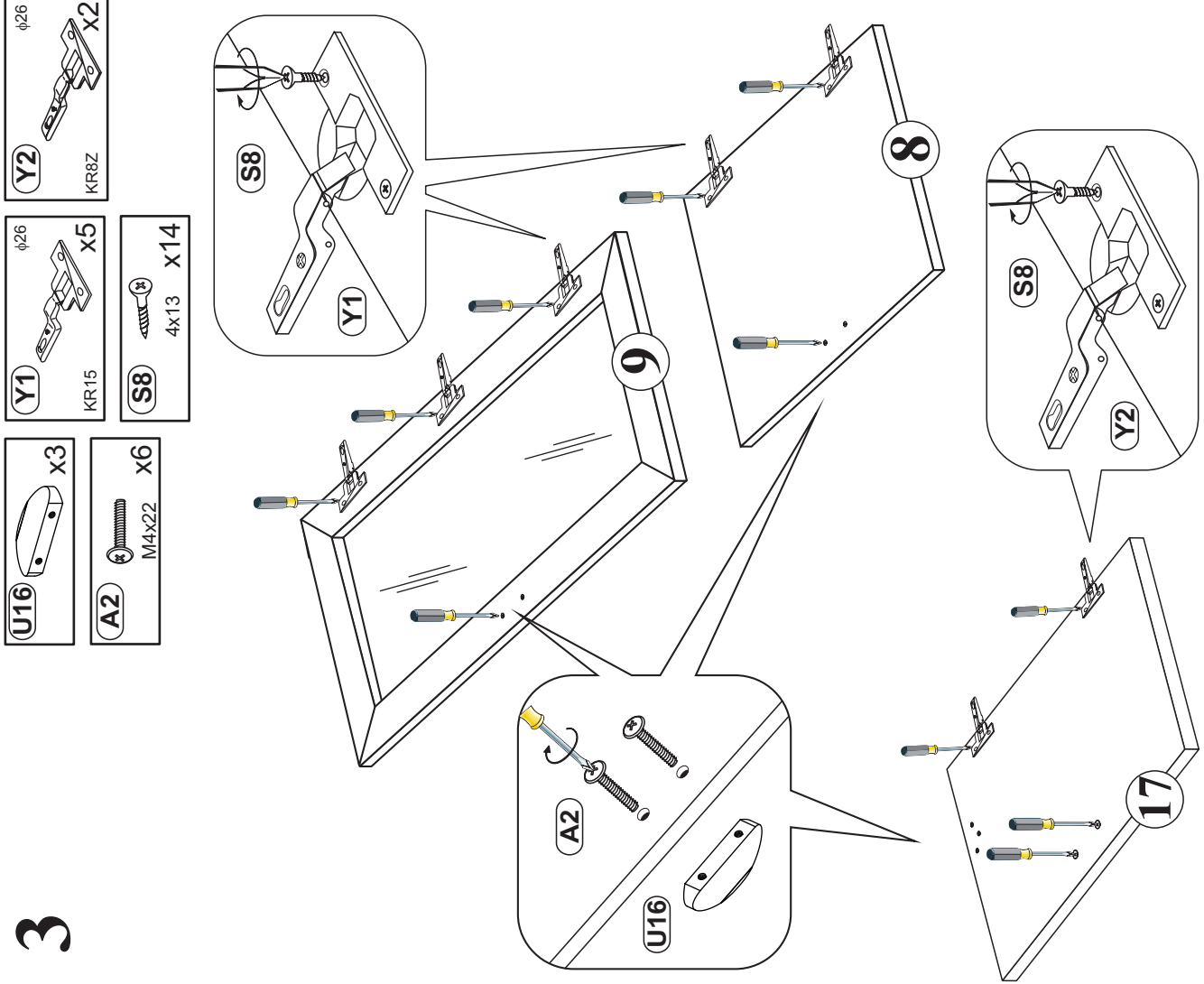

- (U16)** x3
- (A2)** M4x22 x6
- (Y1)** ϕ 26 KR15 x5
- (Y2)** ϕ 26 KR8Z x2
- (S8)** 4x13 x14

Modellname:
Nazwa modelu:

DOVER

Modellreihe:
Numer modelu:

SL--08

Type:
Typ:

16

Blatt Nr
Strona

4 von:
z:

6

4

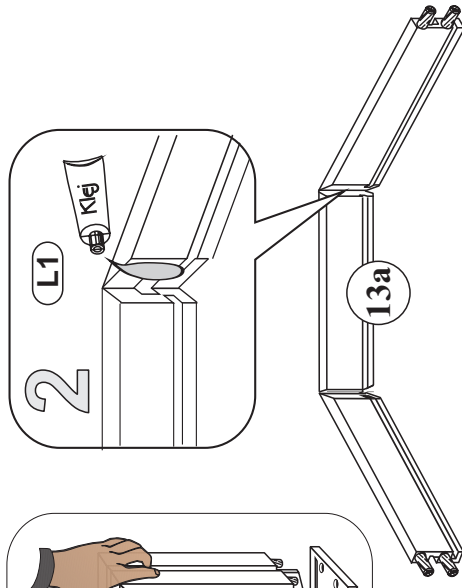
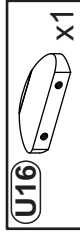
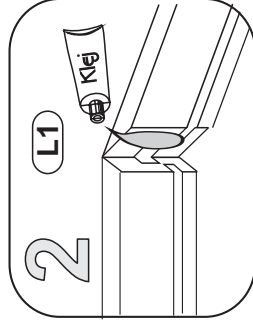
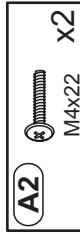
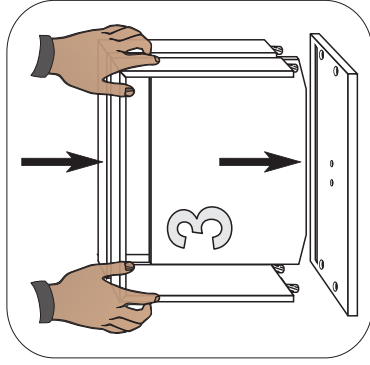

6

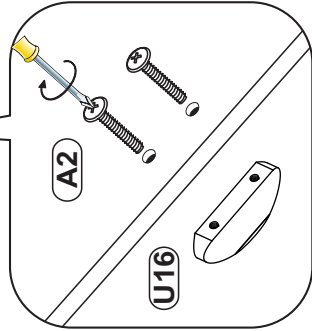
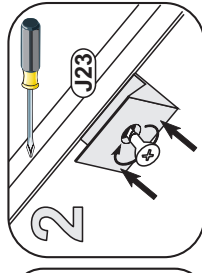
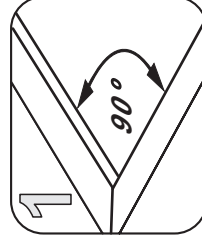
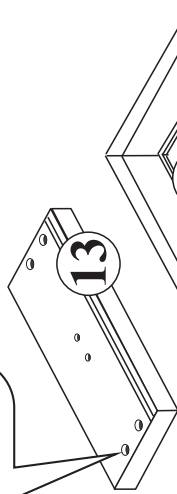
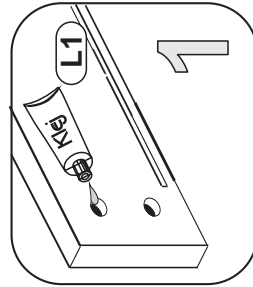
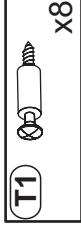
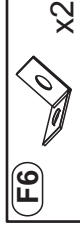

4

7

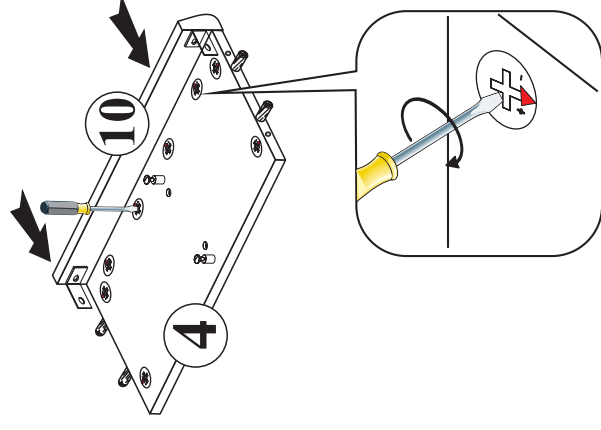
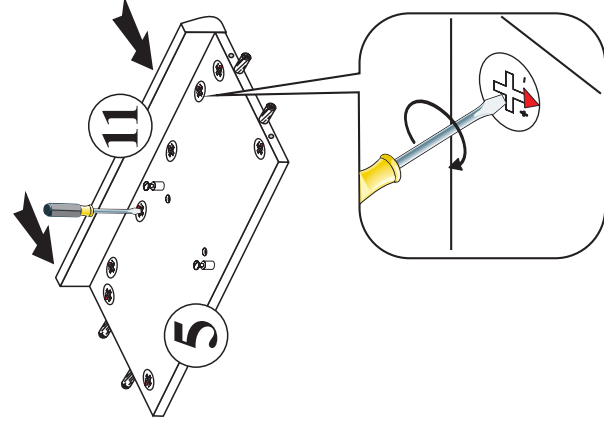

Modellname: **DOVER**
Nazwa modelu:

Modellreihe: **SL -- 08**
Numer modelu:

Type: **16**
Typ:

Blatt Nr **6** von: **6**
Strona z:

11

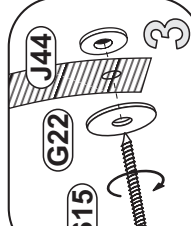
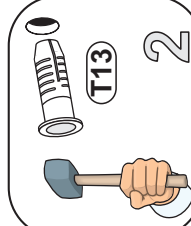
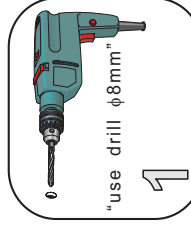
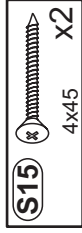
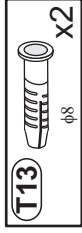

12

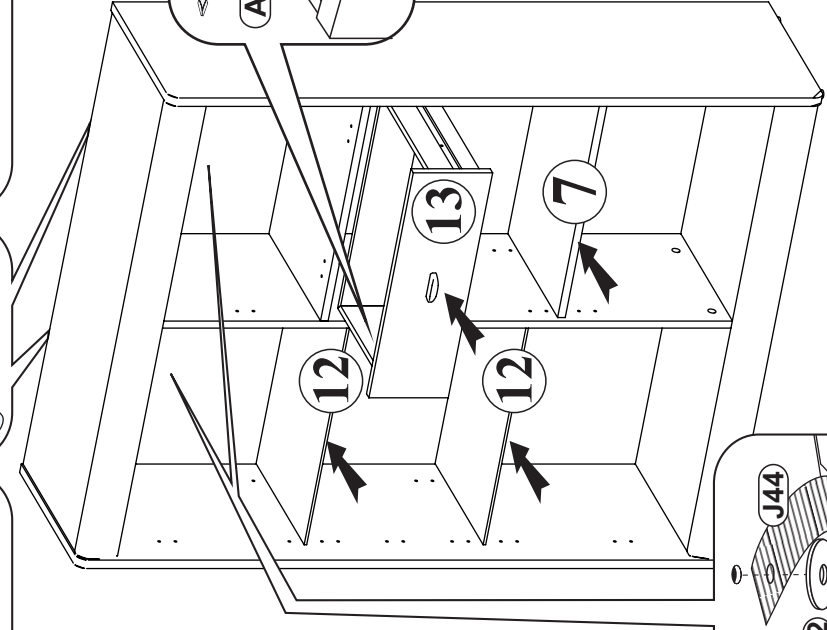
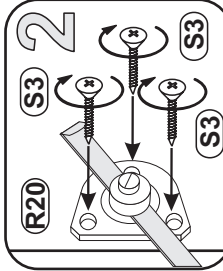
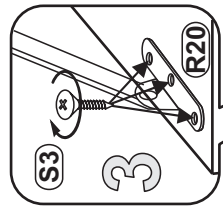

9

